

INNOVATIVE ARCHITECTURE

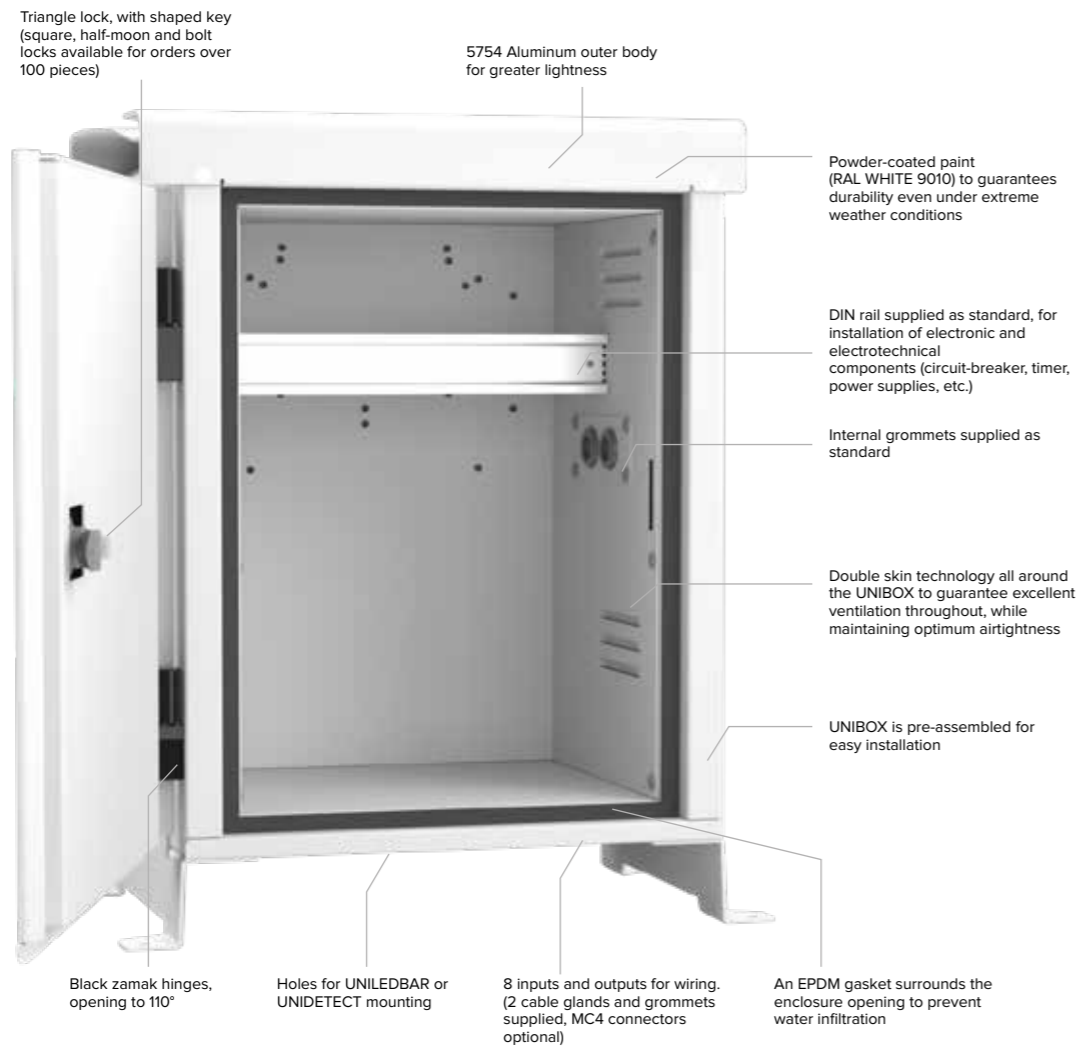

SECURE CLOSURE

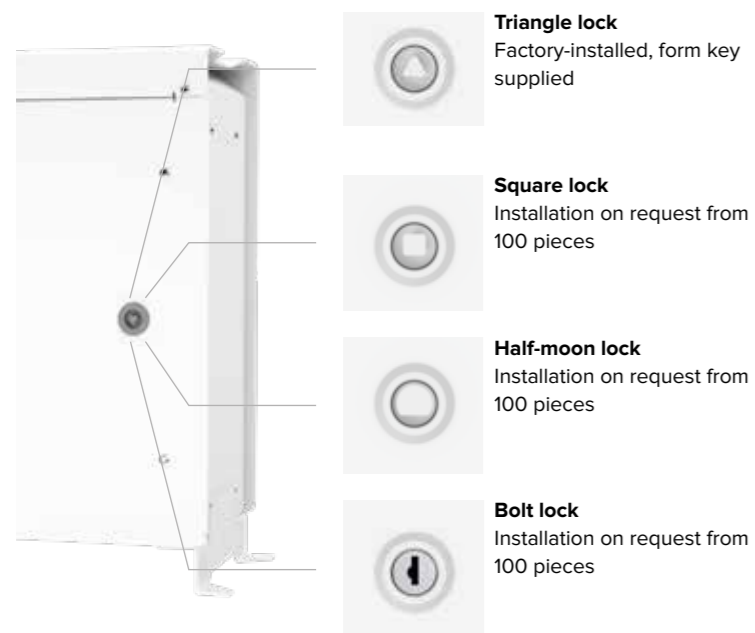

EASY WIRING

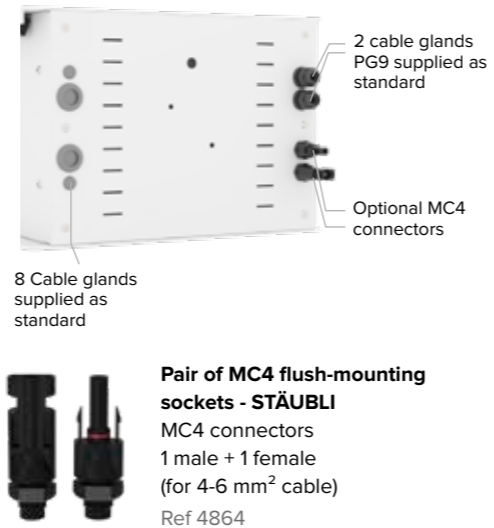

UNIBOX electrical boxes

OPTIMUM PROTECTION

VENTILATED EXTERIOR ELECTRICAL BOXES

The UNIBOX range is ideal for protecting your outdoor electrical equipment. This enclosure accommodates the electrical and electronic equipment needed to supply, distribute and convert the electrical energy of your installation.

With its 5754 aluminum structure, white (RAL 9010) powder-coated surface and corrosion-resistant screws, UNIBOX is perfectly suited to outdoor use. UNIBOX offers a turnkey protection solution, with accessories supplied as standard (cable glands, cable glands, lock, DIN rail, etc.).

Watertightness and ventilation of electronic products and batteries are guaranteed by a high degree of protection (IP 34). UNIBOX has been designed to withstand any weather conditions (rain, snow, hail, etc.) and the passage of solid objects larger than 2.5mm (insects, dust, etc.).

Easy to install, UNIBOX can be mounted :

- wall
- floor
- pole

UNITECK

- IP34** Protection for indoor and outdoor use
- Lightweight (aluminum)
- Corrosion-resistant, Aluminum
- Easy to install
- Wall mounting
- Floor mounting
- Fits all masts

Designed and manufactured in France



REGULATED TEMPERATURE

UNIBOX's Double Skin Technology design ensures good ventilation for optimum internal temperature regulation. UNIBOX optimizes the performance and lifespan of your electrical appliances.

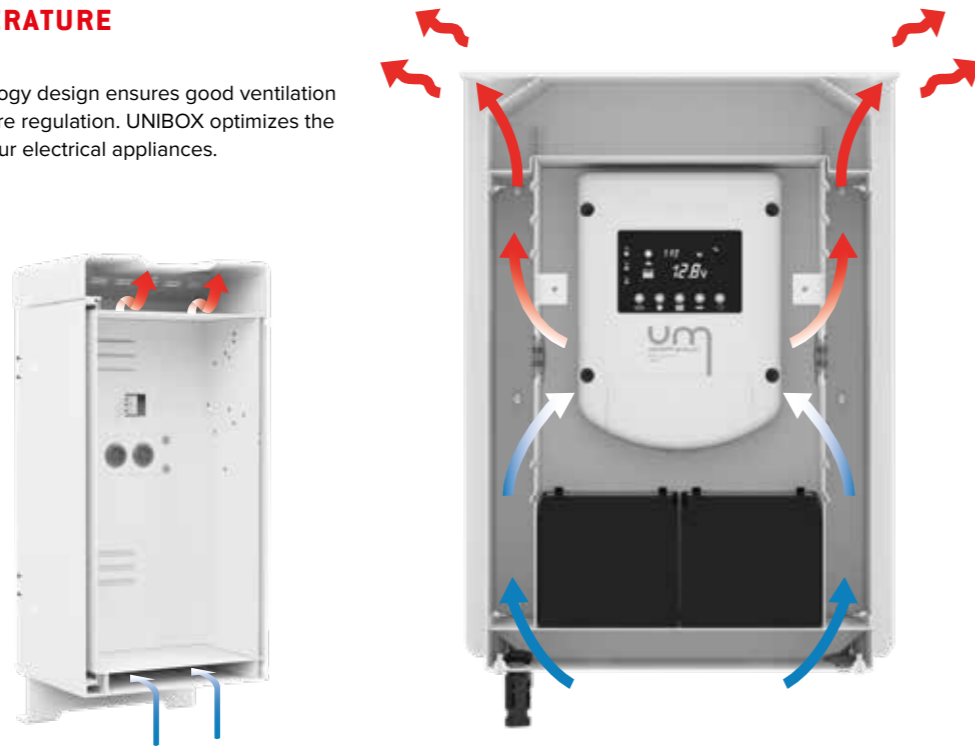

EASY INSTALLATION

UNIBOX provides clean, efficient internal wiring. Double Skin technology provides access to the bottom of the enclosure during assembly. Cable glands and grommets are provided for easy, isolated wiring.

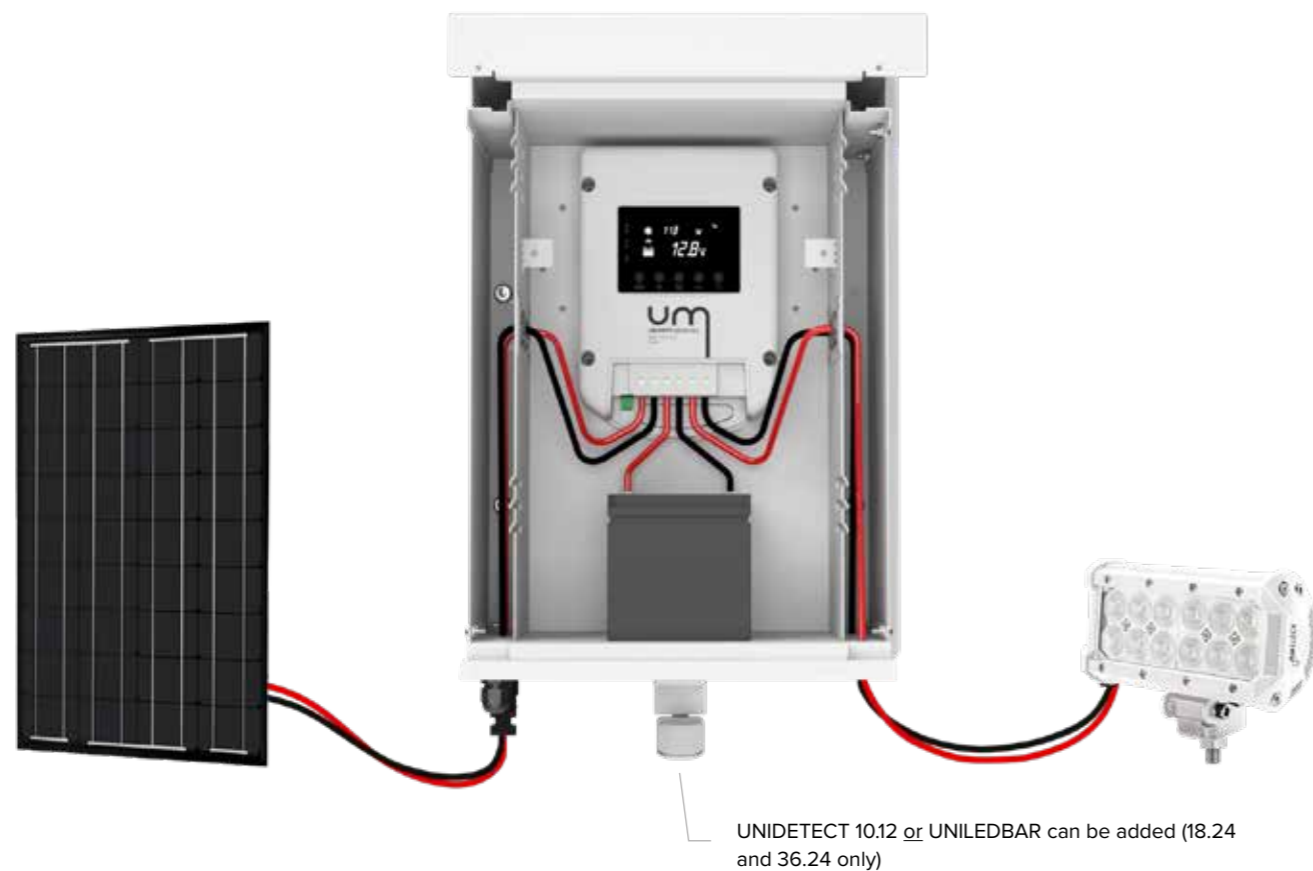

SECURE/IDENTIFIED WIRING

The front panel can be attached to the front using the holes provided. It can be used to add shutters to modular windows, as well as to affix warning or marker labels.



INTERNAL VIEW OF UNIBOX

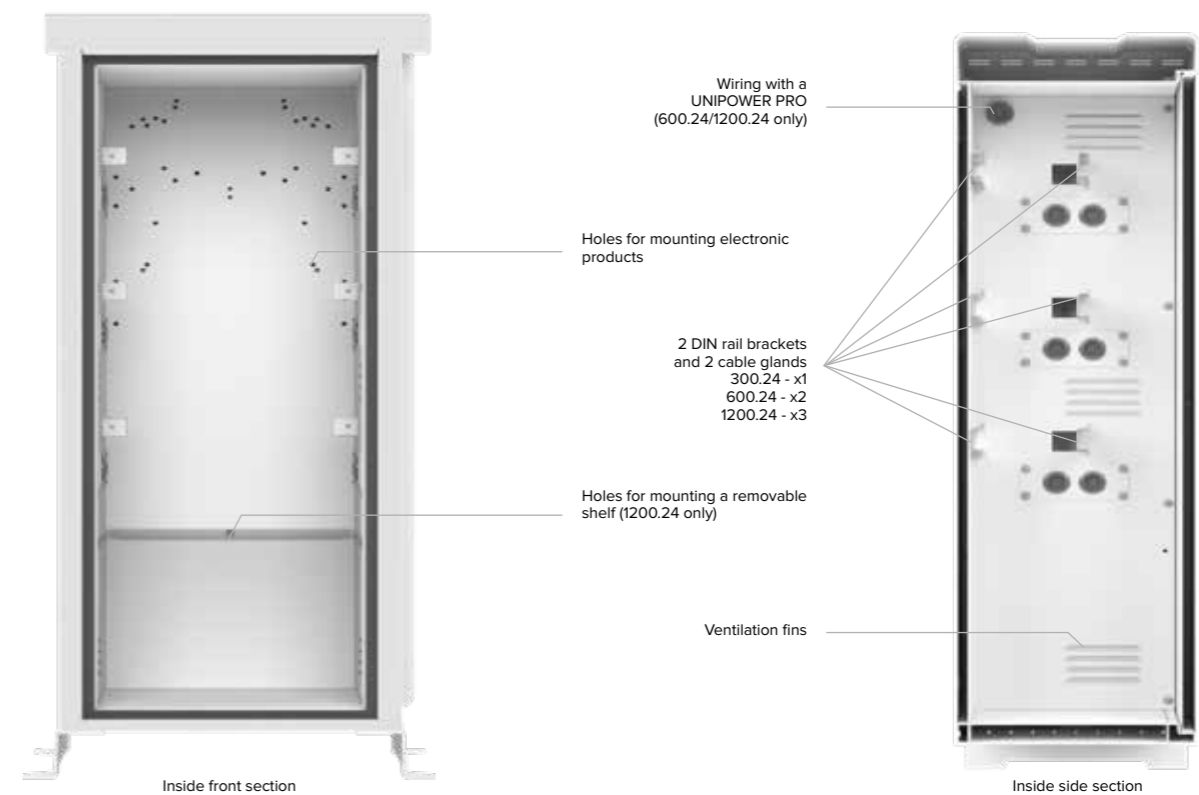

WALL & FLOOR MOUNTING

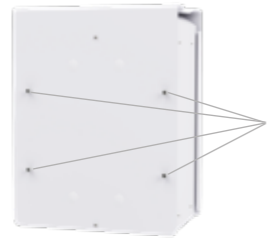

Wall mounting
Original holes and spacers for wall mounting
Ø 6mm
(screws not supplied)



Floor mounting
2 mounting feet
Ref 4277

POLE MOUNTING



Clamp fastening professional strap fasteners
As standard, two holes are drilled to allow the use of "professional" flanges. (see example below)

90 mm centres
Ø 8,5 mm



Mounting on all poles
Fits all types of post from 40 to 250 mm
(Mounting brackets not supplied, see opposite)
For UNIBOX 600.24 and 1200.24, order 2 pieces
Ref 4291



UNIBOX FLANGE STAINLESS STEEL HARDWARE (x2)
Diam 40-60 mm
Ref 2631
Diam 60-90 mm
Ref 2648
Diam 90-130 mm
Ref 2655
Diam 130-190 mm
Ref 2662
Diam 190-250 mm
Ref 4185



UNIBOX 500.24
Ref 4338

UNIBOX 600.24
Ref 4161

UNIBOX 1200.24
Ref 4178

Closing system

Locks	1	2	2
Triangle shape		Original, with supplied key	
Other shapes		On request (+ 100 pieces)	

Interior electrical installation

Internal cable gland	2 x 2	2 x 4	2 x 6
Cable gland PG9 black	2	2	2
External cable gland	8	8	8
Rail DIN (35 x 10 mm)	2	4	6
Compatible batteries			
Bin n°1 - 7-8 Ah (151x65x98 mm)	x 2	x 2	x 4
Bin n°2 - 12-14 Ah (151x100x103 mm)	x 2	x 2	x 4
Bin n°3 - 18-22 Ah (181x77x167 mm)	x 2	x 1	x 4
Bin n°4 - 24-28 Ah (175x166x125 mm)	x 1	x 1	x 2
Bin n°5 - 38-50 Ah (197x165x170 mm)	x 1	-	x 2
Compatible controllers			
UNIMPPT 60/10.24L	-	yes	yes
UNIMPPT 60/20.24L	-	-	yes
UNIMPPT 100/30.24L	-	-	yes
UNISOLAR 10.24L	yes	yes	yes
UNISOLAR 20.24L	yes	yes	yes
Other brands	yes	yes	yes
Compatible converters			
UNIPOWER PRO 800.12	-	yes	yes
UNIPOWER PRO 1200.12	-	-	yes
UNIPOWER PRO 1800.12	-	-	yes
Compatible accessories			
UNITIMER	yes	yes	yes

Technical data

Protection class	IP34		
Impact resistance	IK10		
Materials	Aluminium 5754		
Color	White (RAL 9010)		
Interior dimensions (H x W x D) in mm	340 x 210 x 170	500 x 210 x 170	687 x 210 x 170
External dimensions (H x W x D) in mm	418 x 320 x 225	578 x 320 x 225	765 x 320 x 225
Weight	4 kg	5,5 kg	7 kg

Warranty

Period	2 years	2 years	2 years
--------	---------	---------	---------